

Utilisation à l'extérieur, à la découpe dans le plancher ou le sol, pour une utilisation avec incandescent, Fluorescent, halogène, lampe HID et LED.

- INNER BODY Die-cast aluminium, Polyester powder-coated with high anti-corrosion.
- RECESS BOX Thermoplastic material
- OUTER FRAME Die-cast aluminium
- DIFFUSER Tempered glass, 12mm thickness
- REFLECTOR Polished aluminium
- EQUIPMENT Silicone rubber sealing gaskets; PG13.5 cable gland
- STATIC WEIGHT ALLOWED 2000kgs, maximum velocity of drive-over speed 25km/h.
- IP67, CLASS I

Technical characteristics shall conform to CE standards EN60598.

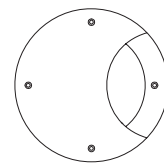

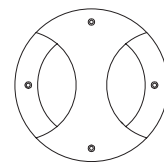

D Version: 1 Opening

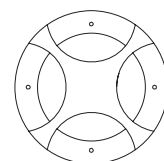

E Version: 2 Opening

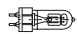
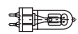
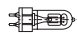

F Version: 4 Opening

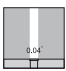
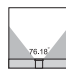
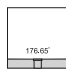
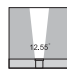
|        |   |   |  |   |
|--------|---|---|--|---|
| lamp   |  |  |  |  |
| code   | 7008D G12<br>70W  | <b>7008E</b> G12<br>70W   | 7008F G12<br>70W   | 7007E PGJ5<br>CDM-Tm 20W  |
| optics |  |  |  |  |
| page   | 9.024   | 9.024   | 9.024  | 9.024   |

# REGINA I

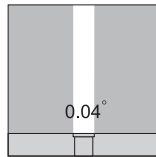
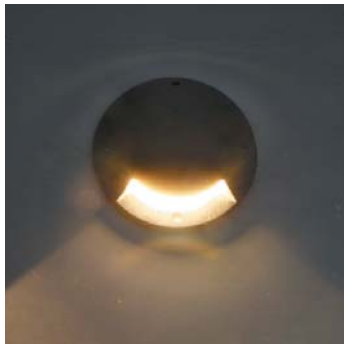

**Item no.**  
7008D

**Watt**  
70W

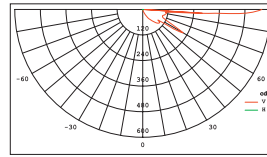

| h(m) | Eavg(lx) | Emax(lx) | D(m) |
|------|----------|----------|------|
| 1    | 0.2196   | 0.2518   | 0    |
| 2    | 0.0549   | 0.0629   | 0    |
| 3    | 0.0244   | 0.028    | 0    |
| 4    | 0.0137   | 0.0157   | 0    |
| 5    | 0.0088   | 0.0101   | 0    |

G12 70W IP67 CLASS I

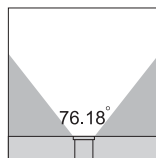
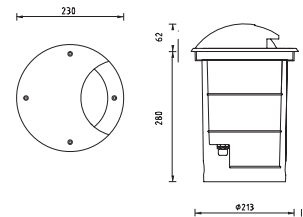

**Item no.**  
7008E

**Watt**  
70W

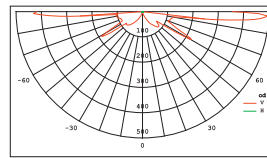

| h(m) | Eavg(lx) | Emax(lx) | D(m) |
|------|----------|----------|------|
| 1    | 12.52    | 33.35    | 1.57 |
| 2    | 3.13     | 8.338    | 3.14 |
| 3    | 1.391    | 3.706    | 4.7  |
| 4    | 0.7824   | 2.084    | 6.27 |
| 5    | 0.5008   | 1.334    | 7.84 |

G12 70W IP67 CLASS I

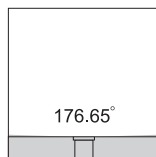
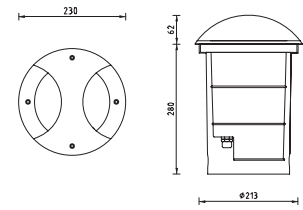

**Item no.**  
7008F

**Watt**  
70W

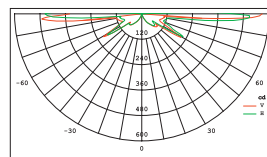

| h(m) | Eavg(lx) | Emax(lx) | D(m) |
|------|----------|----------|------|
| 1    | 0.0616   | 32.06    | 68.4 |
| 2    | 0.0154   | 8.016    | 137  |
| 3    | 0.0068   | 3.563    | 205  |
| 4    | 0.0038   | 2.004    | 274  |
| 5    | 0.0025   | 1.283    | 342  |

G12 70W IP67 CLASS I

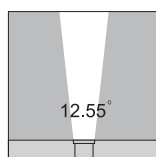
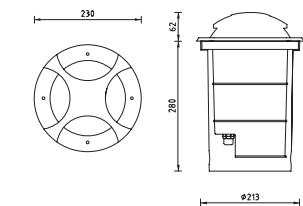

**Item no.**  
7007E

**Watt**  
20W

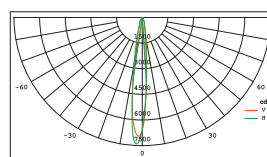

| h(m) | Eavg(lx) | Emax(lx) | D(m) |
|------|----------|----------|------|
| 1    | 4692     | 7666     | 0.22 |
| 2    | 1173     | 1916     | 0.44 |
| 3    | 521.3    | 851.7    | 0.66 |
| 4    | 293.2    | 479.1    | 0.88 |
| 5    | 187.7    | 306.6    | 1.1  |

PGJ5 CDM-Tm 20W IP67 CLASS I

